

## Check Valve Seat Tool

Revision 4/24/24

## 11345 Optional Check Valve

## Seating Tool Kit (For use on Hydraulic Grease Guns)

## Parts &amp; Instructions

1. Unscrew Check Valve Assembly (10) and remove all components from within the Check Valve cavity.
2. Make sure Check Valve cavity is clean and free of debris. To free any trapped particles from the Check Valve seat, clean with a soft bristle wire brush. Be careful not to scratch the Check Valve seat. Blow out any debris from the cavity with an air blow gun.  
**WARNING:** When using an air blow gun be aware of flying debris. Always wear eye protection.
3. Insert new Ball (11) into Check Valve cavity.
4. Screw in Tool Stem (50) hand tight.
5. Tighten Tool Stem (50) ¼ - ½ turn with Hex Wrench (51) 20-25 lb-ft torque.
6. Remove Tool Stem (50) from Check Valve cavity.
7. Leave new Ball (11) in Check Valve cavity. • Do Not reuse the old ball. (11)
8. Assemble other Check Valve Assembly components (10) into Body (1) of the Hydraulic Grease Gun.

## Notes:

It is recommended that a new Check Valve Assembly (10) be installed into Gun after seating the new Ball (11)

The Check Valve seat does not always have to be resealed when repairing or rebuilding a gun. Depending on the amount of damage present on the seat, will determine if the Check Valve seat has to be resealed.

If the Check Valve cavity seat is too damaged, the Body (1) may have to be discarded and replaced.

- This tool (11345) is only necessary for use when repairing or rebuilding dualco hydraulic grease guns.

## Parts List, Ancillary:

• Shown for clarity • Not Included with 11345 Kit

|    |                      |       |
|----|----------------------|-------|
| 1  | Body                 | 10782 |
| 10 | Check Valve Assembly | 10790 |
| 11 | Ball                 | 10904 |
| 12 | Gasket               | 10791 |
| 13 | Check Valve Screw    | 10789 |
| 14 | Filter Screen        | 10793 |
| 15 | Spring               | 10792 |

## Parts List: 11345

• Included with 11345 Kit

|    |                      |       |
|----|----------------------|-------|
| 11 | Ball                 | 10904 |
| 50 | Seat Tool Stem       | 11348 |
| 51 | 90° 5/16" Hex Wrench | 11347 |
| 52 | Brush                | 11092 |

**!** For Industrial Use Only. For more information refer to your original 11000 series instructions or call Dualco for assistance.

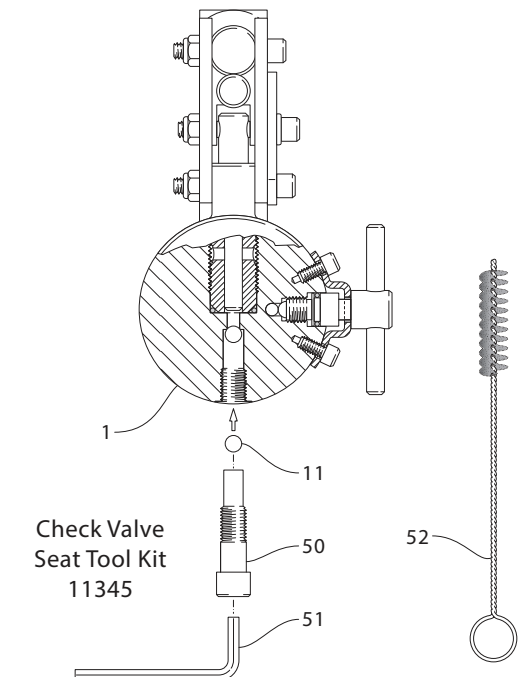
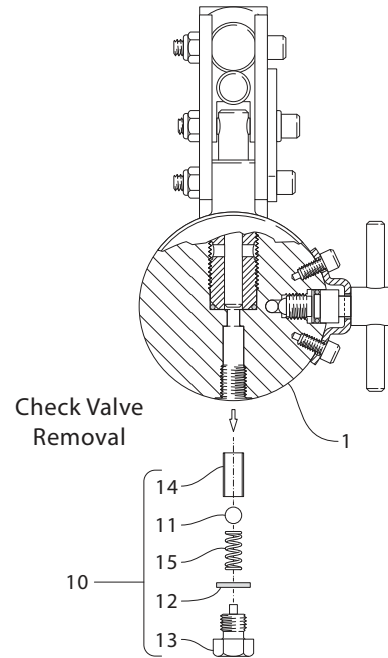

Producing Professional Lubrication products since 1960. Products are made and assembled in the USA. 100% Repairable and Recyclable.

